

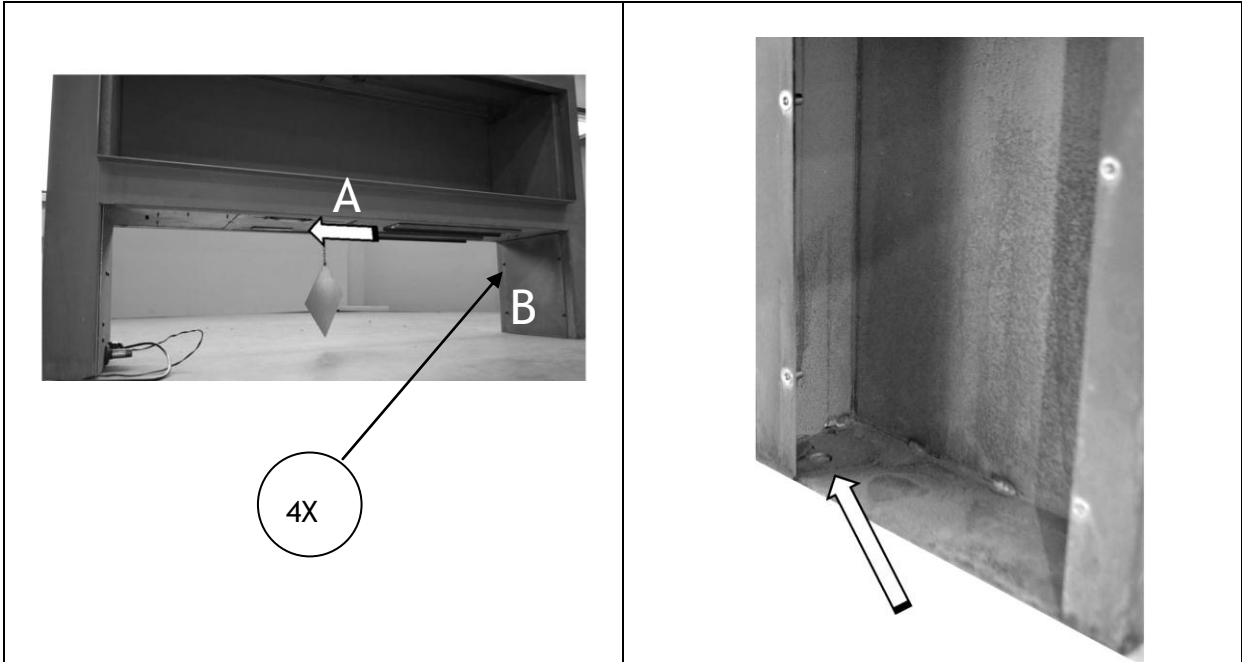

Outdoor fire **theMOOD**

Installation Instruction/
User Manual

40011460 -1326



1.1

1.2

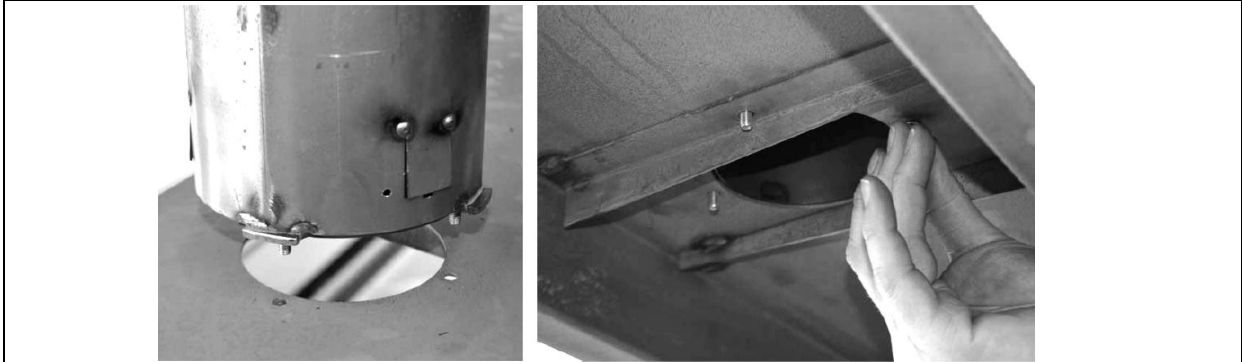

1.3

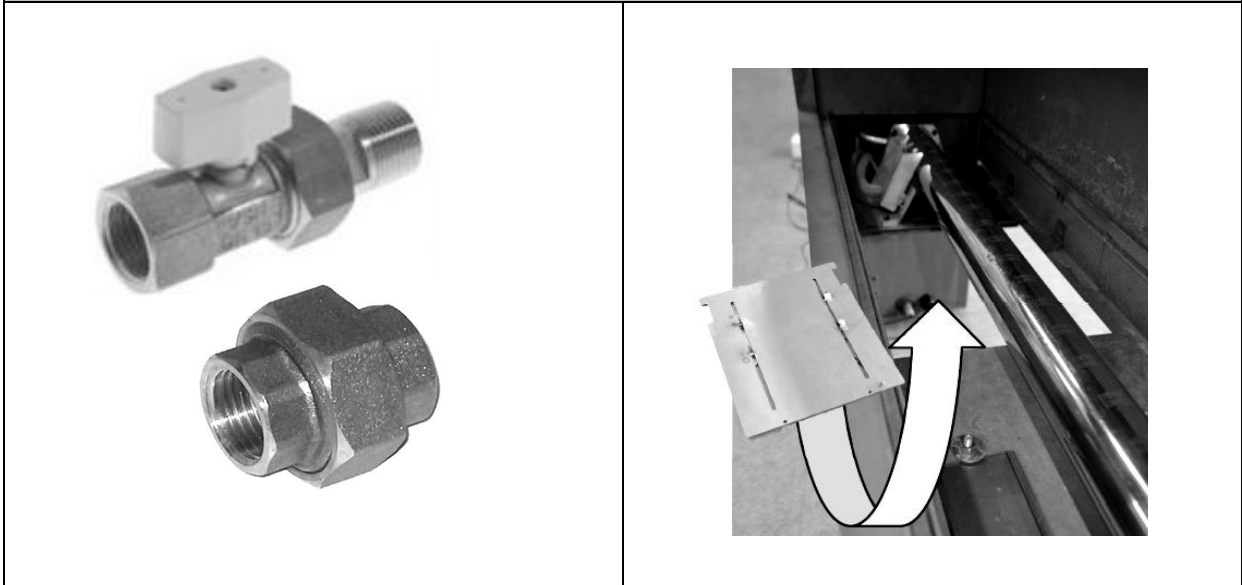

1.4

1.5

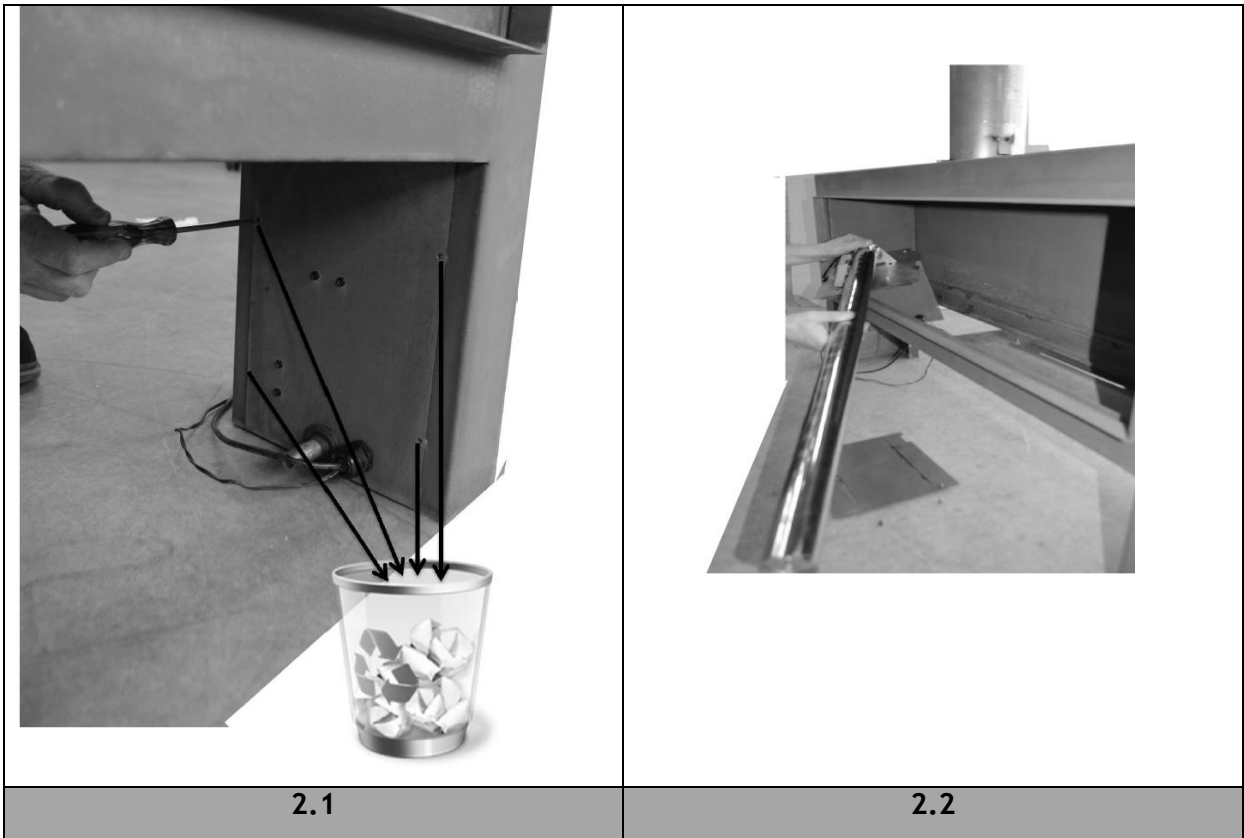
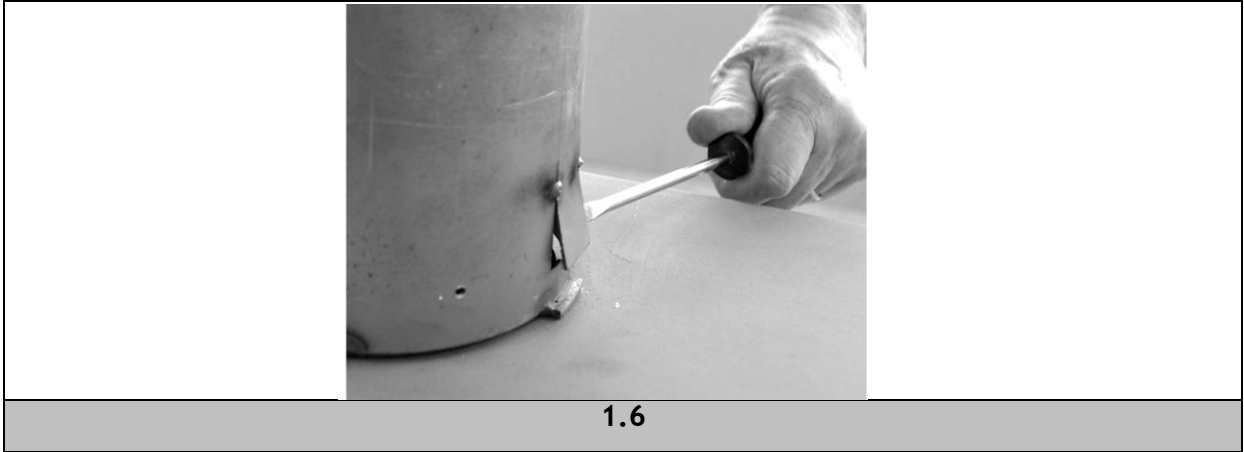

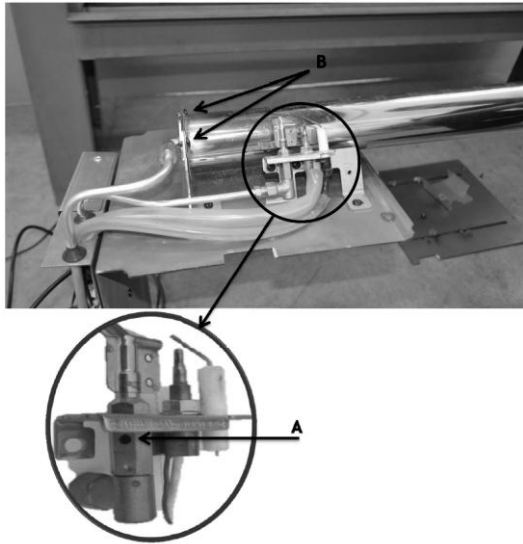

2.3

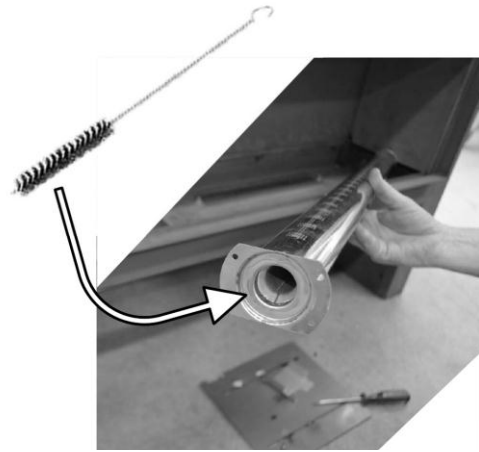

2.4

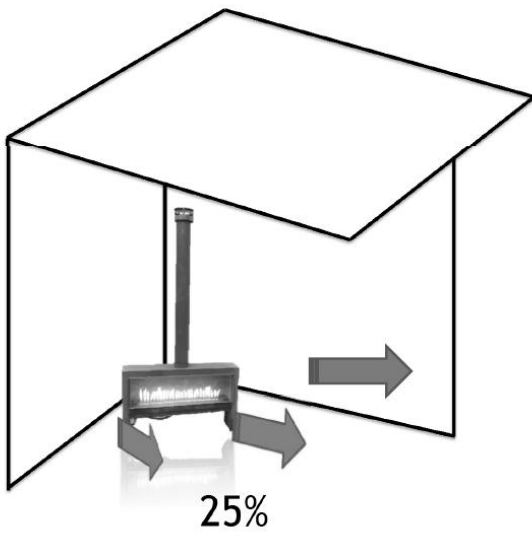

2.5

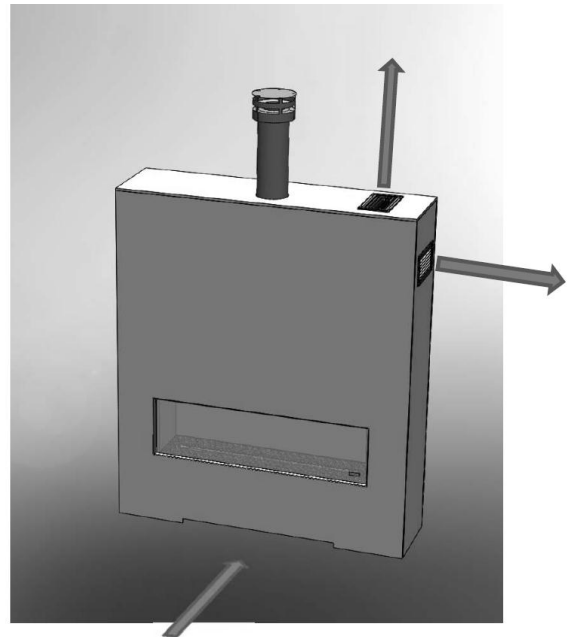

2.6



Min. distance to combustible materials	50cm	30cm	0cm
Flue gas-Exhaust pipe total		X	
Zone A		X	
Zone B	X		

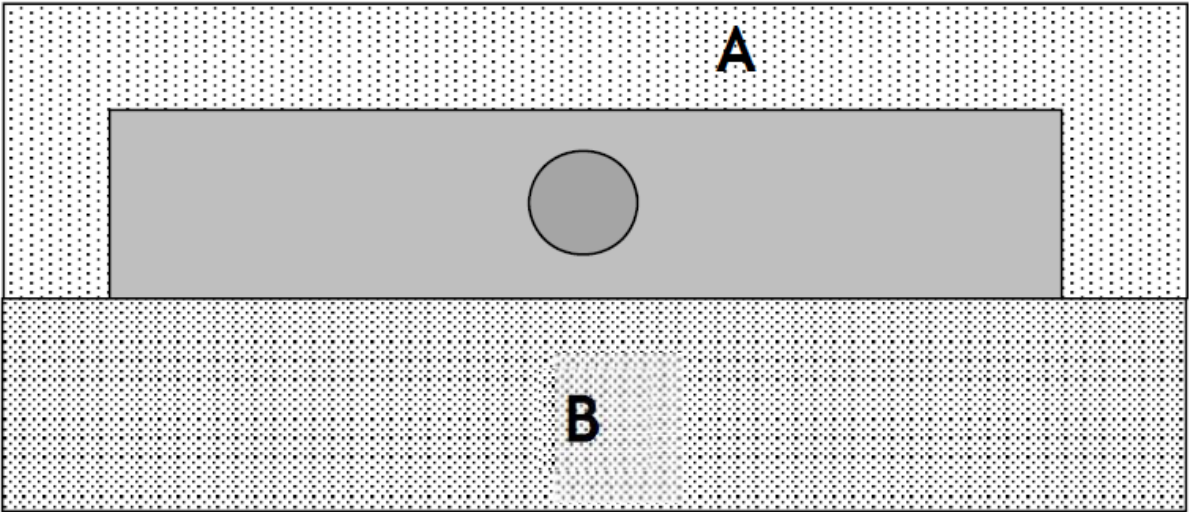

2.7



3.1

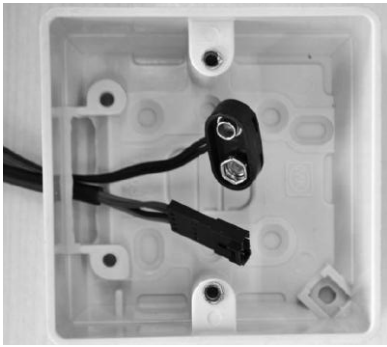

3.2

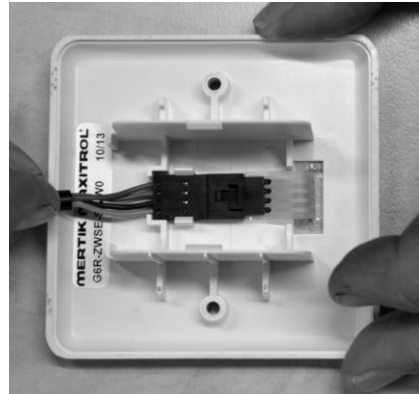

3.3

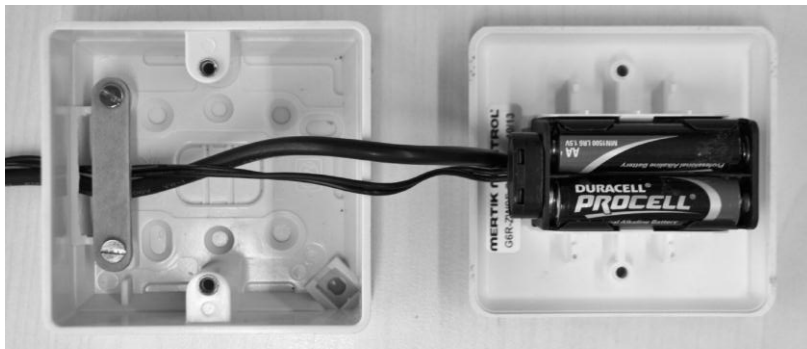

3.4



3.5

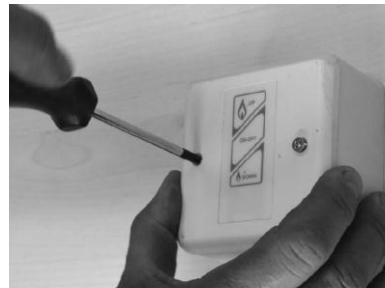

3.6



4.1



4.2

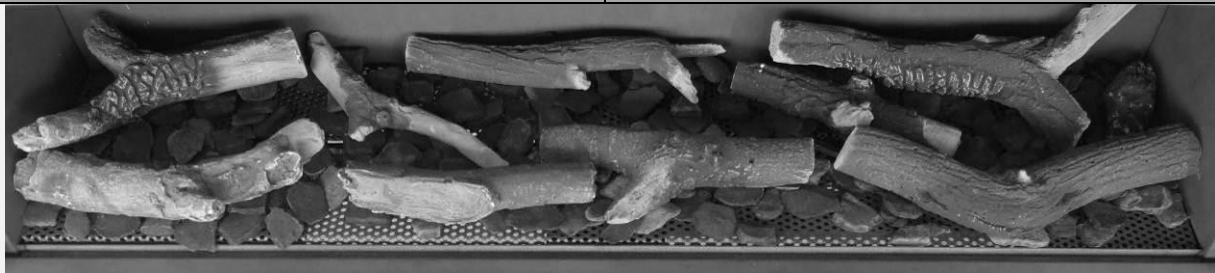

4.3



4.4

1 Introduction

We urgently advice to read this Installation and User Instructions thoroughly. This appliance complies with the guidelines for European gas appliances (gas appliances directive) and bears the CE mark. Keep this Installation and User Instructions for future reference.

2 Product Description

“theMOOD” is a gas appliance made of Corten steel with a single-walled flue pipe of Ø 150 mm and is only intended for outdoor use. The combustion air enters through the bottom and through the gaps into the appliance.

2.1 Corten Steel

- Also known as weathering steel, is a metal alloy consisting of iron to which copper, phosphorus, silicon, nickel and chromium are added. Characteristic of Corten steel is both the brown orange rust color and the durability. The lifetime is so long because the first corrosion layer (patina) prevents further corrosion caused by rust.
- **The color** of the Corten steel develops further and each product is unique. The final appearance, -orange, terra, brown-, depends on conditions such as humidity, temperature and the extent to which the product is exposed to the weather conditions. The steel gets its final color after about 2 years! Keep in mind, that during the formation of this “rust layer” on both the inside and outside of the fireplace rusty water comes from the material, this will leave traces.
- **ATTENTION:** This “rust layer” (patina) is the protective layer of the steel, if this is removed the process will start over again. For example, the presence of wet leaves on Corten steel can leave spots behind on steel.

3 Safety instructions

- Operation area of the fireplace is guaranteed off 0°
- We advise to install the outdoor fireplace somewhat sheltered.
Advantages:

- Less wind sensitive and better stability.
- Intuitively more heat emission.
- **The use of this outdoor fireplace in a confined space is LIFE-THREATENING and is PROHIBITED.**
An installation area must have at least 25% wall surface open to ensure a good ventilation, see detail drawing 2.5.
- In extreme weather conditions we advise to disassemble the flue pipe from the fireplace and to cover the exhaust connector.
- Close the gas tap or pressure regulator after using the outdoor fireplace.
- The outdoor fireplace should be installed and annually checked in accordance with these installation instructions and applicable national and local regulations.
- Check whether the data on the registration plate match the local type of domestic gas and pressure. (for the location of the identification plate, see fig. 1.1 A)
- Do not put any combustible materials, additional imitation logs or glowing coals on the burner or in the combustion chamber.
- The settings and the construction of the outdoor fireplace must not be changed!
- The outdoor fireplace has been designed for ambience and heating purposes. This means that all surfaces, including the glass can get approx. 250°C and the exhaust pipe approx. 400°C. (Exceptions to this are the control knobs)
- Do not place any combustible materials within 0.5 m of the radiation **aria** of the glass. (See also Installation Instruction)

4 Unpacking the appliance

Inspect theMOOD for any transport damage. Please, report transport damage always at your supplier.

You will find:

1. Documents.
 - A. Instruction manual
 - B. Warranty Card
 - C. Log set card
2. Suction Lifters.
3. Glass.
4. Imitation log set with chips or pebbles.
5. Control unit.
6. Exhaust Connector.

Not included:

1. Mounting material.
2. Pressure regulator.

Ordered separately and included:
Box with exhaust pipe.

5 Installation requirements

5.1 Installation of theMOOD

Mount the fireplace leveled on a flat solid surface.

Install the control unit in the field of vision of the outdoor fireplace and in such a way that this is always protected from sunlight and rain and out of the reach of children.

5.2 Electrical connection and cabling

The control unit has standard a cable with a length of 8 meters.

With a connection for battery supply and for the controlling.

Attention: The cables **MAY NOT** be extended.

Longer cables can pick up environmental signals that can switch the appliance uncontrolled On or Off.

5.3 Gas connection

- The gas connection must comply with the local standards.

6 Installation instruction

6.1 General

- Before installing the fireplace, the exhaust connector must be mounted first, place the exhaust connector on the appliance and fix it with the 4 supplied nuts. (see fig. 1.3)
- **ATTENTION:** the temperature of the exhaust pipe can become approx. 400°C, keep this in mind if the exhaust pipe will pass through a lean-to roof.
 - Install the outdoor fireplace leveled on a solid surface, if this is not present then create a foundation The mounting holes are located into the leg of the appliance (see fig. 1.2)
 - First remove the cover plate by means of 4 screws (see fig. 1.1 B)

6.2 Installation gas connection

Install a two-piece gas tap or a flat connection as close as possible to the connection (pipe nipple) of the fireplace. So that for service and maintenance the burner can be disassembled. (See fig. 1.4 and 1.5)

The appliance can be connected to both the gas network and a gas cylinder.

The fireplace should be installed in accordance with these installation instructions and applicable national and local regulations.

At an initial commissioning of a new installation you should remove the air from the gas pipe

Inspect the complete gas connection for leaks.

TIP: For both natural gas or propane, A flexible hose with gas (insert) socket is available at Faber.

Please, contact your dealer for further information. (Mertik Plug 1 connection)

Tips for safe use of gas cylinders

- Gas cylinders always must be standing upright, both during use and transport.
- Place the cylinder at a minimum distance of 1 meter from the fireplace.
- Always use a pressure regulator between the cylinder and the appliance. Replace the pressure regulator every 5 years.
- Use an approved regulator according to local regulations. Pay attention to the correct supply pressure!
- Use only approved gas connection hoses and replace it every 2 years.
- **NEVER** fill gas cylinders with LPG. Leave the filling of gas cylinders to an authorized filling station.
- Replacing the gas cylinder:
 1. Make sure the gas cylinder is placed in a well ventilated area, away from ignition sources (candles, cigarettes or other heat sources).
 2. Connect the pressure regulator to the gas cylinder.
Use a good fitting wrench to unscrew the pressure regulator.
check the gasket ring of the pressure regulator.
 3. You can now replace the gas cylinder. Securing the pressure regulator goes in reverse order.

Check all connections for possible gas leakages.

You can do this with:

- brush with liquid detergent and water.
- spray.



- gas leak detector.

if bubbles appear, you know that there is a leak.

- Attention: Make the checked couplings always dry after inspection.

6.3 Installing exhaust pipe

- Before connecting the exhaust pipe to the connector the resistor tabs must be bent outward.
(see fig. 1.6) repeat this if the exhaust pipe comes loose.
- For TheMOOD a maximum flue length of 1.5 m applies, if the exhaust pipe can be bracketed then this length can be extended up to 2 meters. Extension pipes (1 m.) can be ordered from your dealer.
- When installed under a lean-to roof, at least 1 m. space between the top of the exhaust pipe and the lean-to roof is required. Take in account any discoloration of materials under the lean-to roof.

6.4 Free-standing application

- Refer to Installation Requirements chapter 5 and the Installation Instructions section 6.1 General.
- The minimum distance to combustible materials is 30 cm on the sides and the back of the appliance (see fig. 2.7A). In the radiation area of the glass a distance of 50 cm should be observed. (see fig. 2.7B)

6.5 Build in

- Refer to Installation Requirements chapter 5 and the Installation Instructions section 6.1 General.
- Due to the high temperatures of the fireplace, it should only be built into NON-FLAMMABLE materials. (see fig. 2.7)
- Don't let the casing or breast construction rest on the fireplace.
- For the proper functioning of the fireplace the casing or breast construction should be provided with a ventilation opening at the underside of a minimum of 200 cm² and the space above the fireplace should be open for ventilation. (see fig. 2.6)
- To facilitate removing the burner unit the following points must be carried out:
 1. permanently remove the burner plate screws. (see fig. 2.1)
 2. ensure a minimum of 50 cm extra cable length in the casing or breast construction.

6.6 Installing the control unit

- Refer to Installation Requirements sections 5.1/5.2 and figures 3.1 up to 3.6.
- Determine the location for the control unit.
- Pull the cables through the opening of the surface-mounted socket. (see fig. 3.2)
- Screw the surface-mounted socket on the final spot.
- Make sure you have 12 cm cable length in the surface-mounted socket for replacing the batteries.
- Insert the metal cable relief. (see fig. 3.4)
- Connect the switch with the cable and insert the plug into the terminal. (see fig. 3.3)
- Connect the battery holder with the cable and insert the batteries into the holder. (see fig. 3.5)
- Screw the front panel on the surface-mounted socket. (see fig. 3.6)

6.7 Replacing/inserting batteries

The battery holder is integrated into the control unit. (see fig. 3.5 and 3.6)

- Unscrew the front plate.
- Remove the battery holder.
- Insert 4 pieces of AA/LR6 Alkaline long live batteries.
- Replace the battery holder and mount the front plate.

6.8 Removing glass

- Place the suction lifters on the glass and lift the glass until it is free of the bottom, now pull the bottom of the glass forward. (See fig. 4.1 and fig. 4.2)

To replace the glass repeat the process in reverse order.

Clean all fingerprints on the glass; otherwise they will burn in once the fireplace is used.

The glass is placed slightly loose in the slot by default.

7 Placing decoration material

Do not add different or more materials to the combustion chamber.

Always keep the pilot flame free from decorative materials!

- Place the logs set and chips or pebbles over the burner and cover plate. (see fig. 4.3/4.4 or the Log set

- card)
- Start the fireplace as described in Chapter 8.1.
Assess whether the flame-distribution is good.
- Position the glass and check the fire image.

8 User Instruction

8.1 Igniting the pilot light

If the appliance has not been used for a long time you may need to start several times before the pilot flame ignites.

If you have not used the appliance for an extended period of time, check the ignition of the main burner at full and small position (the ignition must be smooth and quietly).

After changing a gas cylinder, remove the air from the gas pipe

- Open the gas cylinder/gas tap.
- Press the start/stop knob B. (see fig. 3.1)
- The pilot flame will ignite and when the pilot flame burns the main burner switches automatically to high position.
- The ignition must be smooth and quietly.
- Operating the main burner goes by means of the control knob A for high and C for low.

8.2 Turning off the pilot light

The pilot flame is turned off by means of a press on the start/stop knob B. (see fig. 3.1)
We advise you to close the gas tap if you have turned off the fireplace.

9 Instructing the client

- Recommend that the appliance be serviced annually by a qualified installer in order to guarantee safe use and long lifecycle.
- Point the customer on the service life of the gas hose and pressure regulator.
- Advise and instruct the client about maintenance and cleaning of the glass. Emphasize the risk of burnt-in fingerprints.
- Instruct the customer on the operation of the appliance.
- Hand over to the client:
 - Installation Instructions
 - Suction lifters
 - Log set card

10 Annual maintenance

10.1 Check:

In case of build-in, for service and maintenance the two-piece gas tap or flat coupling and electric cables are accessible through the service hatch in the fireplace. (see fig. 1.5)

Check and clean if necessary:

- The pilot flame, especially the primary air opening. (see fig. 2.3)
- The burner, especially the primary air opening. (see fig. 2.4)
- The glass.
- Gas connection/gas hose and pressure regulator.
- Checking for gas leakage.
- Ignite the burner as described in section 8.1.
- Check the ignition of the main burner at full mark and low mark.
(the ignition must be quick and easy).

10.2 Cleaning the glass

Most of the deposits can be removed with a dry cloth. You can use a ceramic hob cleaner to clean the glass. Note: Prevent fingerprints on the glass. They will burn in once the fireplace is used and cannot be removed!

10.3 Conversion to a different type of gas (e.g. natural gas)

This can only be done by installing a correct burner unit. Please contact your supplier. Always submit the type and serial number of the fireplace when ordering.



11 Technical specifications

Gas category		II2H3P	II2H3+	II2H3P
Appliance type		A1 (outdoor)	A1 (outdoor)	A1 (outdoor)
Reference gas		G20	G30	G31
Load Hi	kW	12.4	12.4	12.4
Inlet pressure	mbar	20	30	37
Gas flow rate at full load	M ³ /h	1,303	0,374	0,496
(At 15°C and 1013 mbar)	gr/h	-	940	930
Burner pressure at full load	mbar	13	18.2	24.7
Nozzle main burner	mm	ST1100	ST500	ST500
Pilot light		OP9040	OP9226	OP9226
Gas control valve		GV60	GV60	GV60
batteries		4x AA (1.5V)	4x AA (1.5V)	4x AA (1.5V)

12 Dimensional drawing

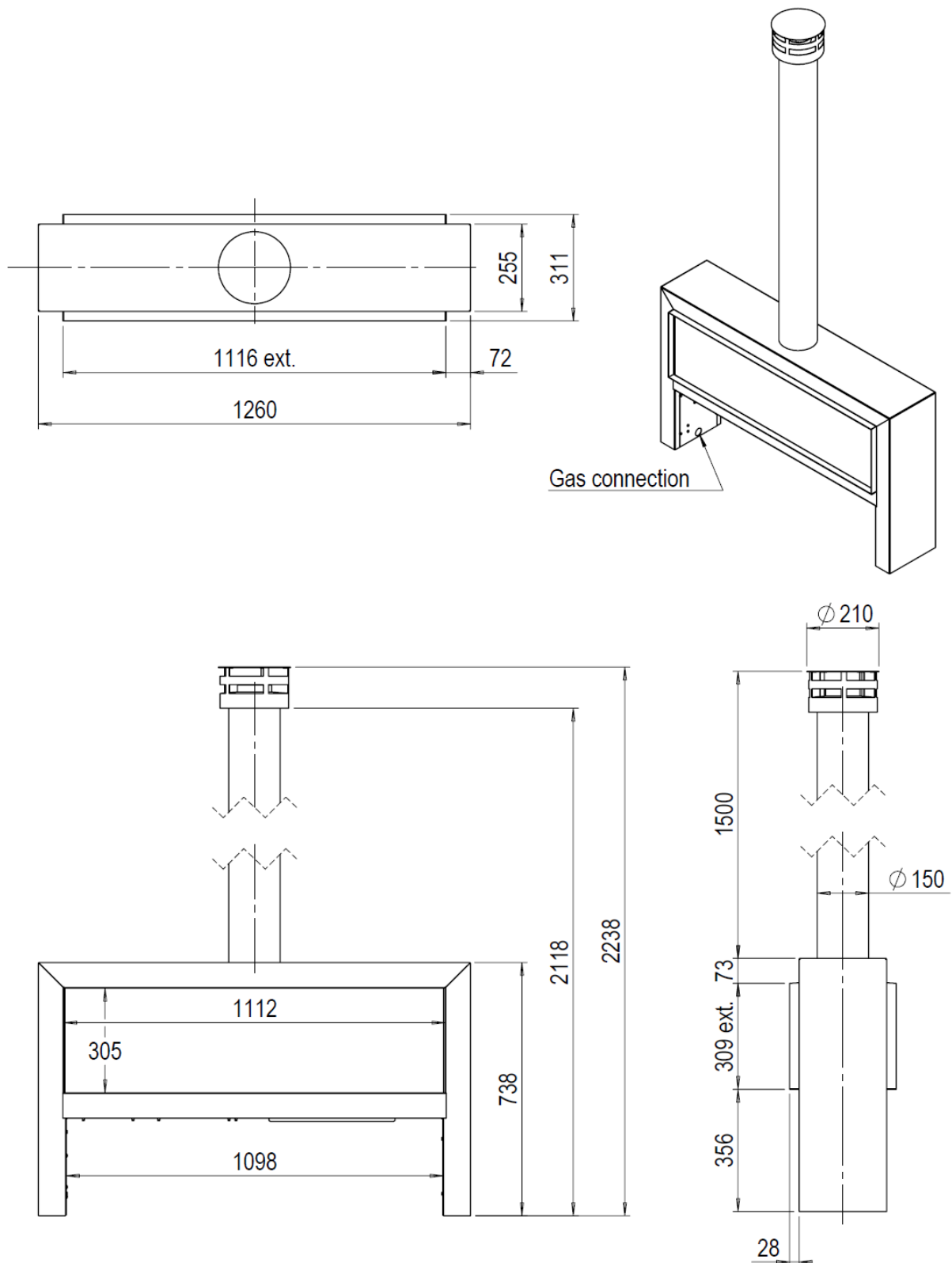







www.faber.nl - info@faber.nl

Saturnus 8 NL - 8448 CC Heerenveen

Postbus 219 NL - 8440 AE Heerenveen

T. +31(0)513 656500

F. +31(0)513 656501

